

Vitri Electro-Metalúrgica, S.A.

Barcelona

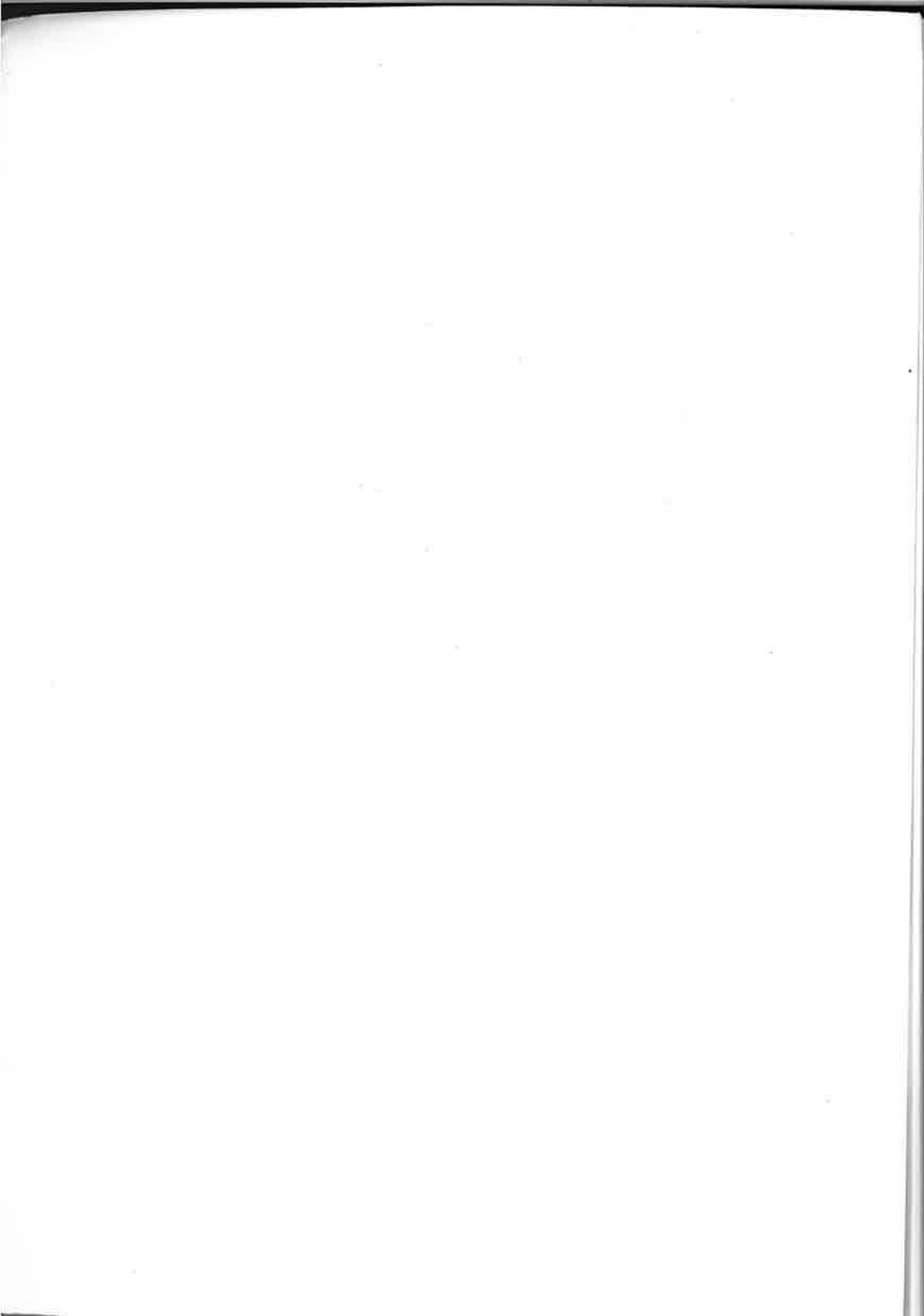



VITRI ELECTRO - METALURGICA, S. A.

VILADOMAT, 321 - 2.º — 08029 BARCELONA - ESPAÑA

Tel. (93) 321 76 50

Télex: 51 814 VEM-E

Telefax n.º 410 3952

CASQUILLOS PARA LAMPARAS ELECTRICAS

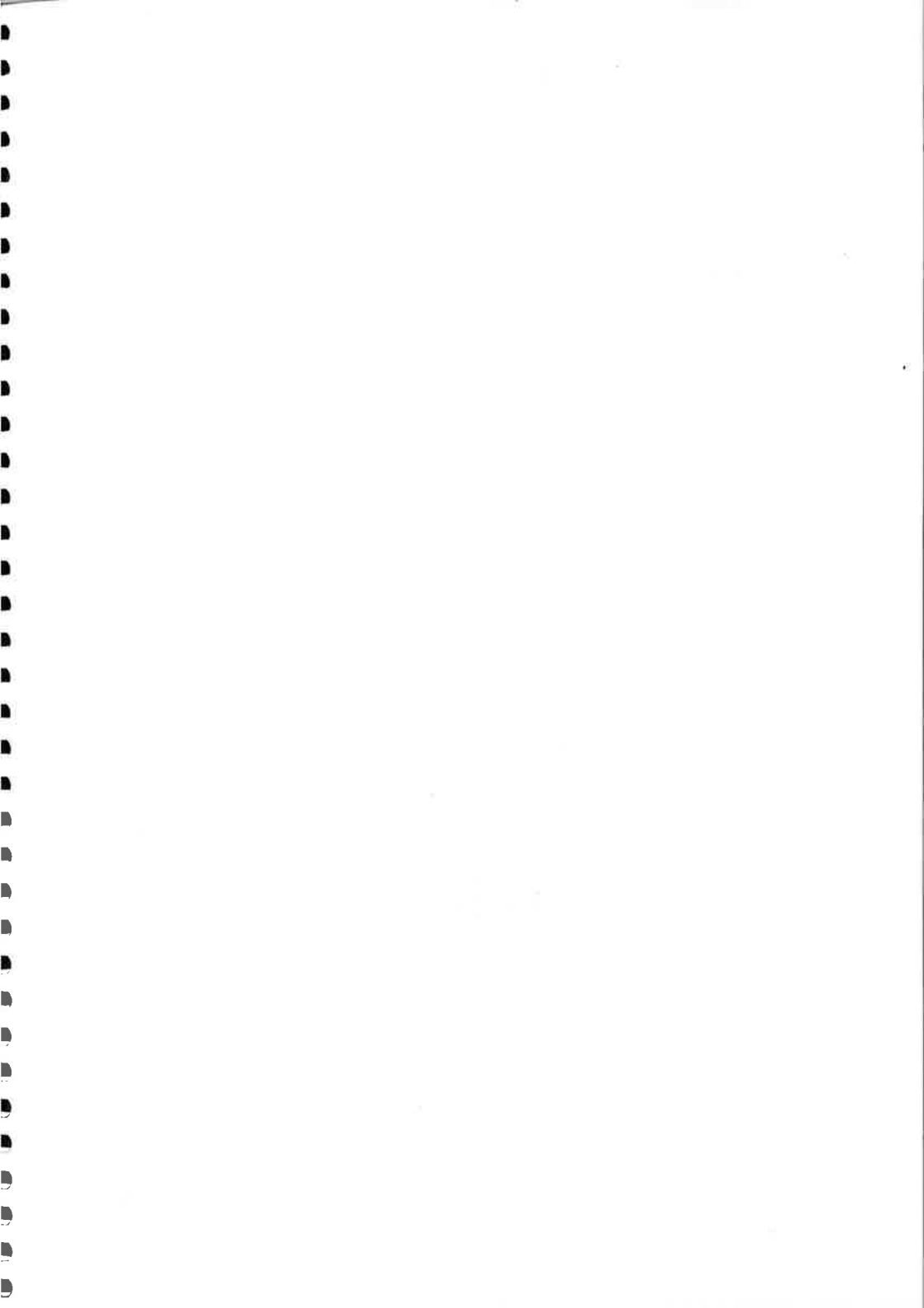

GENERALIDADES SOBRE CASQUILLOS PARA LAMPARAS ELECTRICAS

De acuerdo con la Comisión Electrotécnica Internacional (I.E.C.), la denominación de los casquillos para lámparas se expresa de la siguiente forma:

1. Una letra o letras que indican el tipo de casquillo:
 - B — indica bayoneta.
 - BA — indica bayoneta automóvil.
 - E — indica rosca.
 - G — indica una o más patas de contacto.
 - P — indica prefocus.
 - S — indica camisa cilíndrica.
 - SV — indica camisa con final cónico.
2. Un número que sigue a la letra o letras, indicando el valor aproximado en milímetros de la dimensión principal del casquillo, a saber:
 - Para B, BA, S, SV, el diámetro de la camisa.
 - Para E, el diámetro exterior de la rosca.
 - Para G, la distancia entre patas de contacto.
 - Para P, el diámetro de la parte por la cual la lámpara se posiciona lateralmente.
3. Una letra minúscula indicativa del número de contactos.
 - s — Para un contacto.
 - d — Para dos contactos.
 - t — Para tres contactos.
4. Un número precedido de un barra (/) indicando en milímetros la longitud aproximada del casquillo, incluyendo el aislante.
5. Un número precedido por el signo de multiplicación (\times) indicando en milímetros el diámetro aproximado de la valona o cerrado de la boca del casquillo en el caso de que lo tengan.

Teniendo en cuenta de que éste es un catálogo comercial, las tolerancias se han excluido de los dibujos, pero la dimensiones estándar más importantes, están indicadas en las páginas 169 y 171.

INTERNATIONAL DESIGNATION OF LAMP CAPS

According to the regulations of the International Electrotechnical Commission, the designation of the lamp caps is made by the following systems:

1. A letter or letters indicate the cap construction:
B — means bayonet.
BA — means bayonet automobile.
E — means screw thread.
G — means two or more contact pins.
P — means prefocus.
S — means shell.
SV — means shell with conical end.
2. A number following the letter(s) indicates the approximate value in mm. of the principal dimension of the cap, viz:
For B, BA, S and SV, the diameter of the shell.
For E, the crest diameter of the screw thread.
For G, the pin spacing.
For P, the diameter of the part by which the lamp is located laterally.
3. A small letter indicating the number of contacts:
s — for one.
d — for two.
t — for three.
4. A number preceded by an oblique stroke, giving in millimetres the approximate over-all length of the cap, including protruding insulation.
5. A number preceded by the multiplication sign (\times), giving in millimetres the approximate outside diameter of the skirt. In the case of a spun-in cap, the approximate diameter of the open end of the shell.

Since this is a commercial catalogue, the tolerances have been excluded from the designs, but the most important standard dimensions are indicated in pages 169 and 171.

INDICE GENERAL

Denominación I.E.C.	Código	Página
E 10/13	E 10.1.220	11
E 10/16x12	E 10.1.2	13
E 10/17x11	E 10.1.52	13
E 10/19x13	E 10.1.723	13
E 10/20x13	E 10.1.51	13
E 10/24x15	E 10.1.593	13
E 12/25x17	E 12.1.2517	15
E 14/15	E 14.1.58.1	17
E 14/19	E 14.1.58	17
E 14/20	E 14.1.357	17
E 14/20	E 14.2.357.1	17
E 14/22	E 14.1.357.2	17
E 14/21x15	E 14.1.307.1	19
E 14/23x15	E 14.1.307	19
E 14/23x15	E 14.2.307.2	19
E 14/25x17	E 14.2.340.1	21
E 14/25x17	E 14.1.340.3	21
E 14/25x17	E 14.2.340.2	23
E 14/25x17	E 14.1.340.4	23
E 14/34x26	E 14.1.376	25
E 26/24	E 26.2.E2624	27
E 26/24	E 26.1.E2624.1	27
E 26/24	E 26.2.E2624.2	29
E 26/24	E 26.1.E2624.3	29
E 26/50x39	E 26.1.E2650	31
E 27/25x22	E 27.1.60.2	33
E 27/27	E 27.1.60	35
E 27/27	E 27.2.60.6	37
E 27/27	E 27.1.60.7	37
E 27/27	E 27.2.60.5	39
E 27/27	E 27.1.60.14	39
E 27/27	E 27.1.60.13	41
E 27/27	E 27.1.Z60.1	43
E 27/30	E 27.1.A27	45
E 27/30	E 27.1.A27.2	47
E 27/36x30	E 27.1.B27	49
E 27/43x38	E 27.1.238	51
E 27/51x39	E 27.1.E2751	53
E 39/41	E 39.1.E3941	55
E 39/45	E 39.1.E3945.2	55
E 40/41	E 40.1.239.7	57
E 40/45	E 40.1.239.10	57
E 40/45	E 40.1.239.13	57
E 40/45	E 40.1.239.12	59
E 40/45	E 40.1.239.9	61
E 40/42	E 40.1.239.8	63

Denominación I.E.C.

Código

Página

E 40/45	E 40.1.239.6	63
É 40/45	E 40.1.239.5	65
E 40/45	E 40.1.239.1	67
B 15d/22x17	B 00.1.3054.3	69
B 15d/24x17	B 00.1.3054.1	69
B 22d/22	B 22.1.603	71
B 22d/25x26	B 22.1.613	73
B 22d/25x26	B 22.2.613.2	73
B 22d-3 (90°/135°)/25x26	B 22.1.70	75
BA 9s/13	BA 9.1.35.2	77
BA 9s/14	BA 9.1.35	77
BA 9s/14x8	BA 9.1.35.1	79
BA 9s/13x8'2	BA 9.1.35.4	81
BA 9s/14x8	BA 9.1.35.6	81
BA 15s/19	B 15.1.536	83
BA 15s/20	B 15.1.536.3	83
BA 15s/19	B 15.1.536.2	85
BA 15s/20	B 15.1.536.7	85
BA 15s/19	B 15.1.536.4	87
BA 15s/20	B 15.1.536.6	87
BA 15d/19	B 15.1.574	89
BA 15d/20	B 15.1.574.9	89
BA 15d/19	B 15.1.574.10	91
BA 15d/20	B 15.1.574.4	91
BA 15d/19	B 15.1.574.6	93
BA 15d/20	B 15.1.574.2	93
BAY 15d/19	BAY 1.41.1	95
BAY 15d/20	BAY 1.41	95
BAY 15d/19	BAY 1.41.3	97
BAY 15d/20	BAY 1.41.6	97
BAY 15d/19	BAY 1.41.4	99
BAY 15d/20	BAY 1.41.7	99
BA 20s/25	B 20.1.649	101
BA 20s/25	B 20.1.649.1	103
BA 20s/26	B 20.1.649.2	103
BA 20d/25	B 20.1.650	105
BA 20d/26	B 20.1.650.2	105
BA 20(Cazoleta)	B 20.1.CAZ	107
BA 21s-3 (120°)/20	B 21.1.5	109
BA 21s-3 (120°)/21	B 21.1.5.2	109
BA 21s-4 (60°-120°)/20	B 21.1.5.3	111
BA 21d-3 (120°)/20	B 21.1.5 Bis	113
BA 21d-3 (120°)/21	B 21.1.5 Bis.7	113
BA 21d-4 (60°-120°)/20	B 21.1.5 Bis.8	115
BA 21 (Cazoleta)	B 21.1.CAZ	117
SV 6-5,5/6,5	SVO. 1.42	119
SV 6-5,5/6,5	SVO. 1.42.2	121
SV 7-7,3/8,5	SVO. 1.40 Bis	123
SV 8,5-8/9,5	SVO. 1.44	125
SV 8,5-8/9,5	SVO. 1.44.1	127
SV 9,5-8,5/10	SVO. 1.43	129
S 14s	S 14.1.S14s	131

Denominación I.E.C.

Código

Página

S 15/15	S 15.1.48.1	133
S 15/20	S 15.1.48	133
S 15/20	S 15.2.48.6	133
S 15s/17	S 15.1.48.10	135
S 15s/18	S 15.1.48.11	135
S 15s/19	S 15.1.48.9	135
S 19/19	S 19.1.50	137
S 19/19	S 19.2.50.1	139
S 19/20	S 19.2.50.4	139
S 19/21	S 19.2.50.5	139
S 19/20	S 19.1.50.6	141
S 19/20	S 19.2.50.2	141
S 22s/21	S 22.1.45.1	143
S 22d/21	S 22.1.45	145
P 36	P 36.1.46	147
P 28s/24	P 28.1.62	149
P 28(Cazoleta)	P 28.1.CAZ	151
P 45t-41	P 45.5.78.1	153
G 16t/23x22	G 16.5.9N	155
G 5/11x15	G 1Z.2.Z1511	157
G 13/9,5x24	G 2Z.2.Z249,5	159
G 13/10x24	G 2Z.2.Z2410	159
G 13/11x24	G 2Z.2.Z2411	159
G 13/12x24	G 2Z.2.Z2412	159
G 13/10x35	G 30.2.03510	161
G 13/10,5x35	G 30.2.03510,5	161
G 13/11x35	G 30.2.03511	161
G 13/10x35	G 3T.2.T3510	163
G 13/9,5x35	G 3Z.2.Z359,5	165
G 13/10x35	G 3Z.2.Z3510	165
G 13/11x35	G 3Z.2.Z3511	165
G 13/12x35	G 3Z.2.Z3512	165

E 10

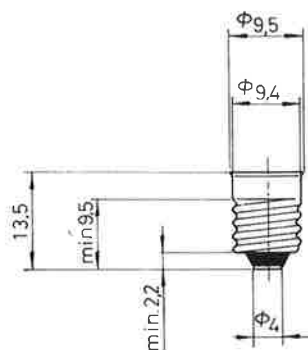

Desig. I.E.C.	Código				Mat.
E 10/13	E 10.1.220				CuZn

E 10

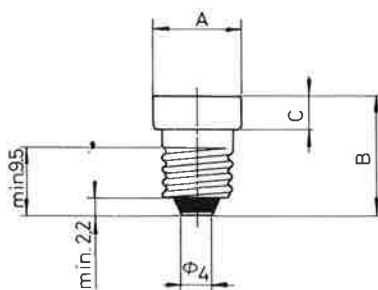

Desig. I.E.C.	Código	A	B	C	Mat.
E 10/16x12	E 10.1.2	12	16	4,5	CuZn
E 10/17x11	E 10.1.52	11	17,5	6	CuZn
E 10/19x13	E 10.1.723	13	19	5	CuZn
E 10/20x13	E 10.1.51	13	20	7	CuZn
E 10/24x15	E 10.1.593	15	24	9	CuZn

E 12

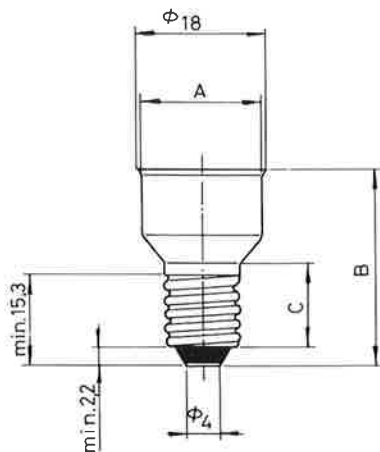

Desig. I.E.C.	Código	A	B	C	Mat.
E 12/25x17	E 12.1.2517	17	25	12,5	CuZn

E 14

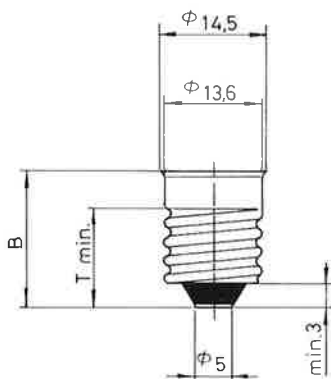

Desig. I.E.C.	Código	B	T		Mat.
E 14/15	E 14.1.58.1	15	12		CuZn
E 14/19	E 14.1.58	19	16		CuZn
E 14/20	E 14.1.357	20,7	16		CuZn
E 14/20	E 14.2.357.1	20,7	16		Al.
E 14/22	E 14.1.357.2	22	16		CuZn

E 14

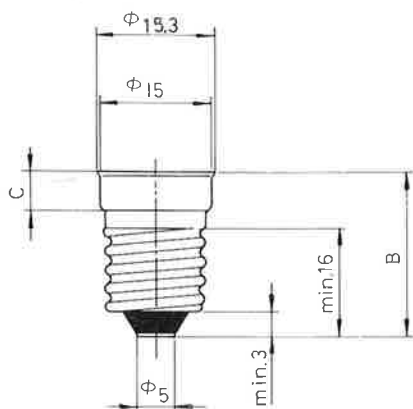

Desig. I.E.C.	Código	B	C		Mat.
E 14/21x15	E 14.1.307.1	21	4		CuZn
E 14/23x15	E 14.1.307	23,5	5,5		CuZn
E 14/23x15	E 14.2.307.2	23,5	5,5		Al.

E 14

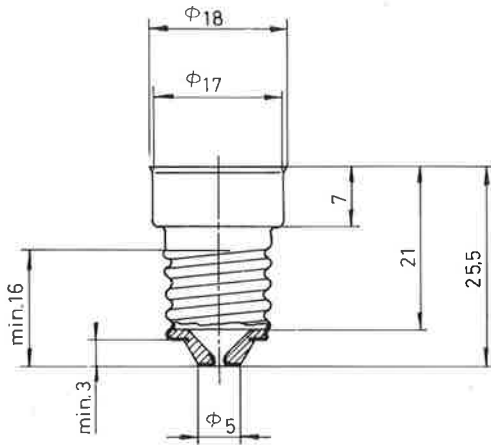

Desig. I.E.C.	Código				Mat.
E 14/25x17	E 14.2.340.1				Al
E 14/25x17	E 14.1.340.3				CuZn

E 14

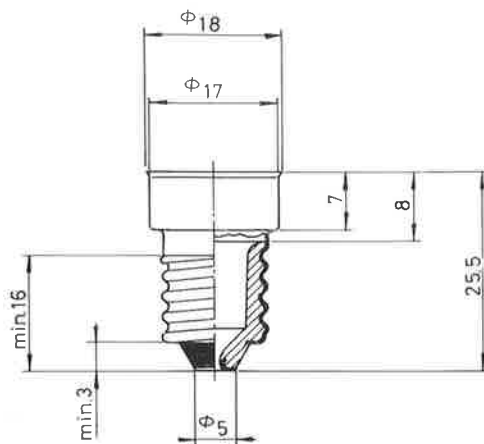

Desig. I.E.C.	Código				Mat.
E 14/25x17	E 14.2.340.2				Al.
E 14/25x17	E 14.1.340.4				CuZn

E 14

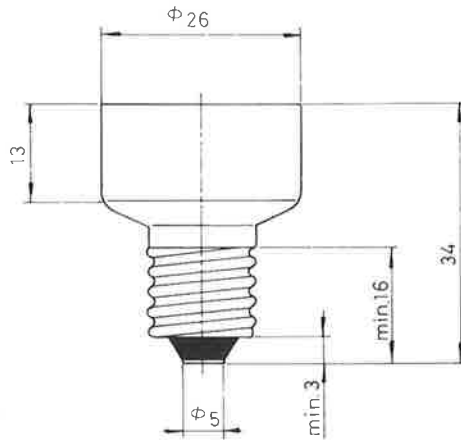

Desig. I.E.C.	Código				Mat.
E 14/34x26	E 14.1.376				CuZn

E 26

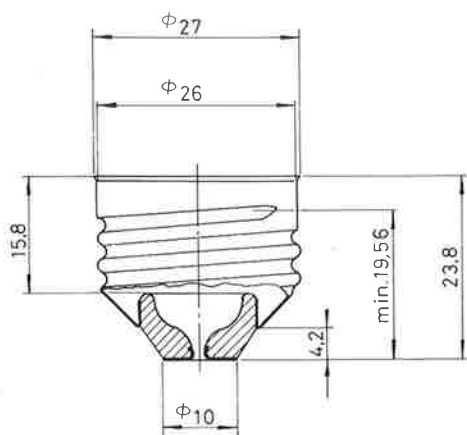

Desig. I.E.C.	Código				Mat.
E 26/24	E 26.2.E2624				Al.
E 26/24	E 26.1.E2624.1				CuZn

E 26

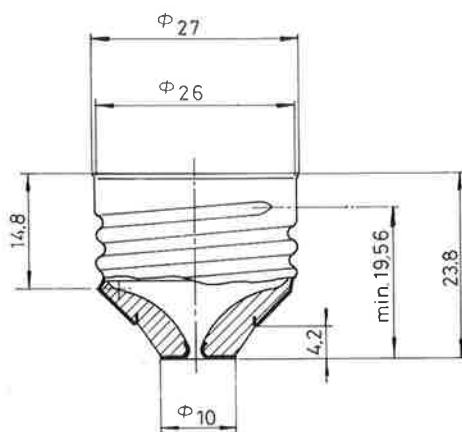

Desig. I.E.C.	Código				Mat.
E 26/24	E 26.2.E2624.2				Al.
E 26/24	E 26.1.E2624.3				CuZn

E 26

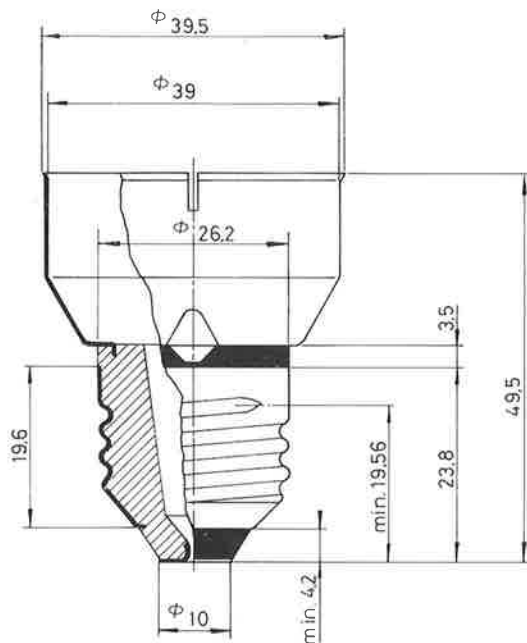

Desig. I.E.C.	Código	n.º entallas			Mat.
E 26/50x39	E 26.1.E2650	2			CuZn

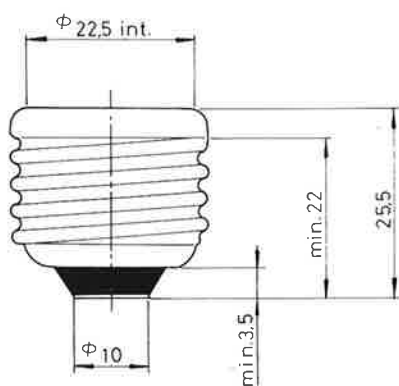

Desig. I.E.C.	Código				Mat.
E 27/25x22	E 27.1.60.2				CuZn

E 27

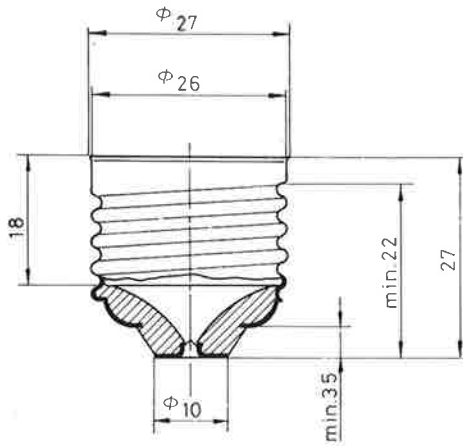

Desig. I.E.C.	Código				Mat.
E 27/27	E 27.1.60				CuZn

E 27

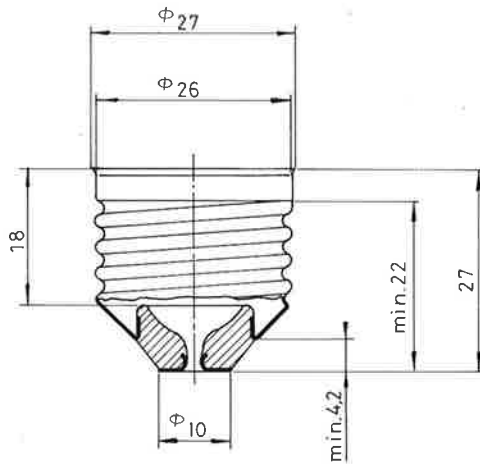

Desig. I.E.C.	Código				Mat.
E 27/27	E 27.2.60.6				Al.
E 27/27	E 27.1.60.7				CuZn

E 27

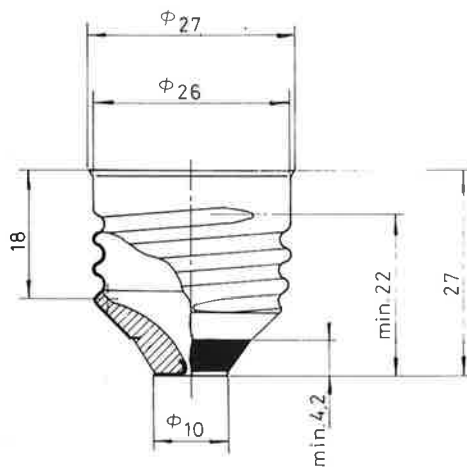

Desig. I.E.C.	Código				Mat.
E 27/27	E 27.2.60.5				Al.
E 27/27	E 27.1.60.14				CuZn

E 27

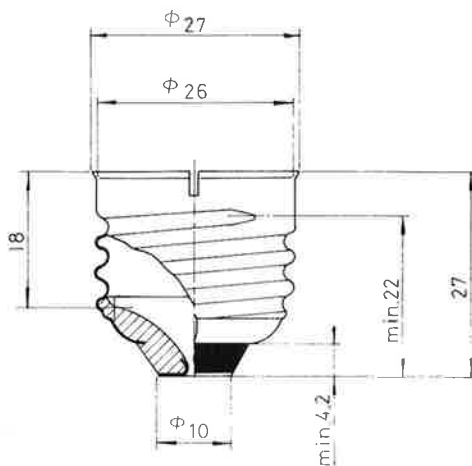

Desig. I.E.C.	Código		n. ^o entallas		Mat.
E 27/27	E 27.1.60.13		4		CuZn

E 27

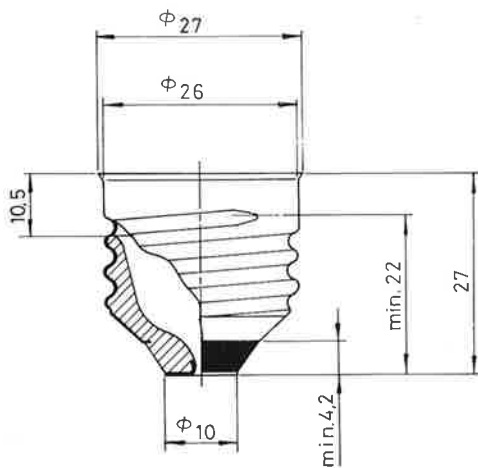

Desig. I.E.C.	Código				Mat.
E 27/27	E 27.1.Z60.1				CuZn

E 27

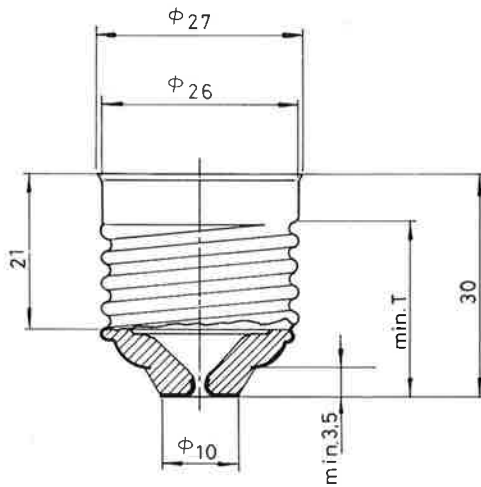

Desig. I.E.C.	Código	T			Mat.
E 27/30	E 27.1.A27	22			CuZn

E 27

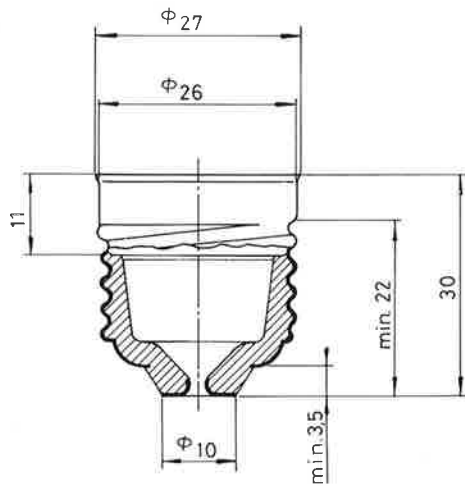

Desig. I.E.C.	Código				Mat.
E 27/30	E 27.1.A27.2				CuZn

E 27

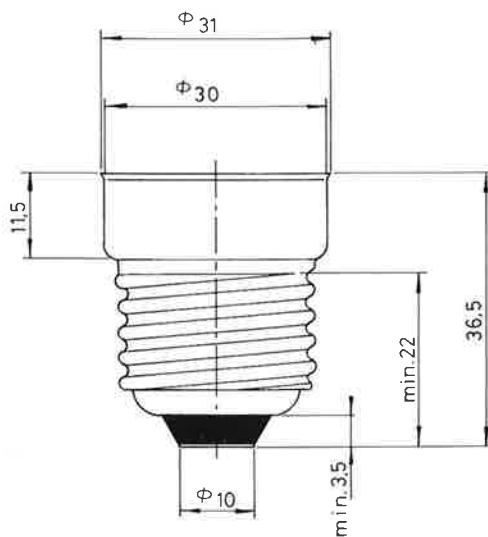

Desig. I.E.C.	Código				Mat.
E 27/36x30	E 27.1.B27				CuZn

E 27

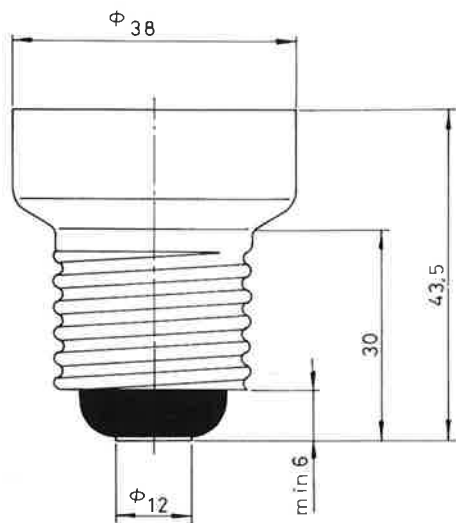

Desig. I.E.C.	Código				Mat.
E 27/43x38	E 27.1.238				CuZn

E 27

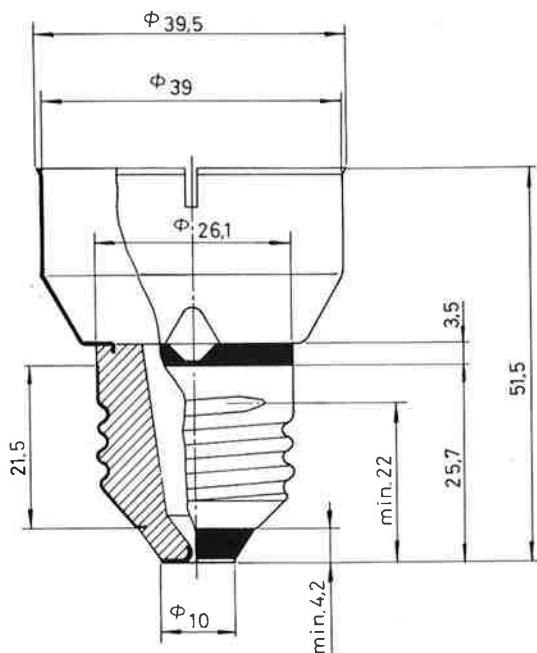

Desig. I.E.C.	Código	n.º entallas			Mat.
E 27/51x39	E 27.1.E2751	2			CuZn

E 39

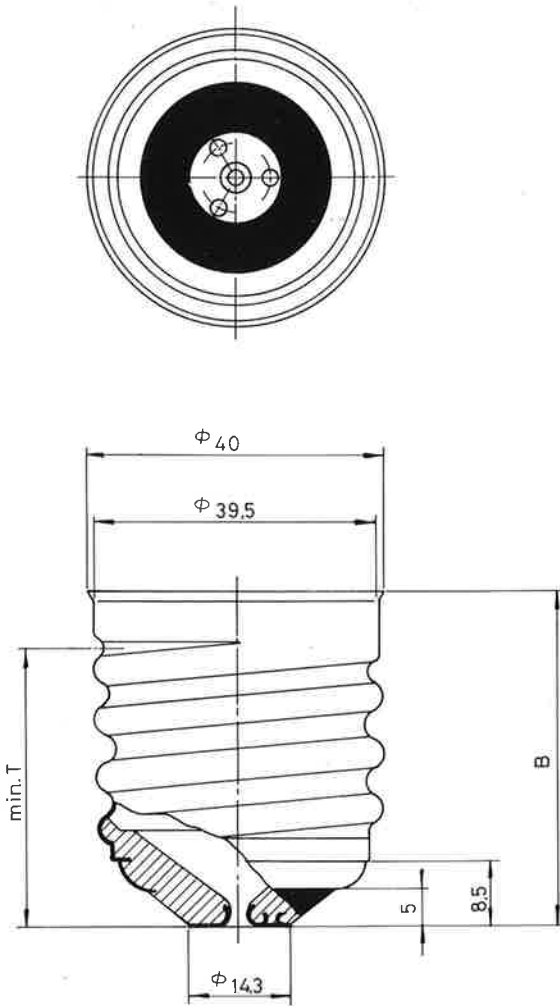

Desig. I.E.C.	Código	B	T		Mat.
E 39/41	E 39.1.E3941	41	34		CuZn
E 39/45	E 39.1.E3945.2	45	41		CuZn

E 40

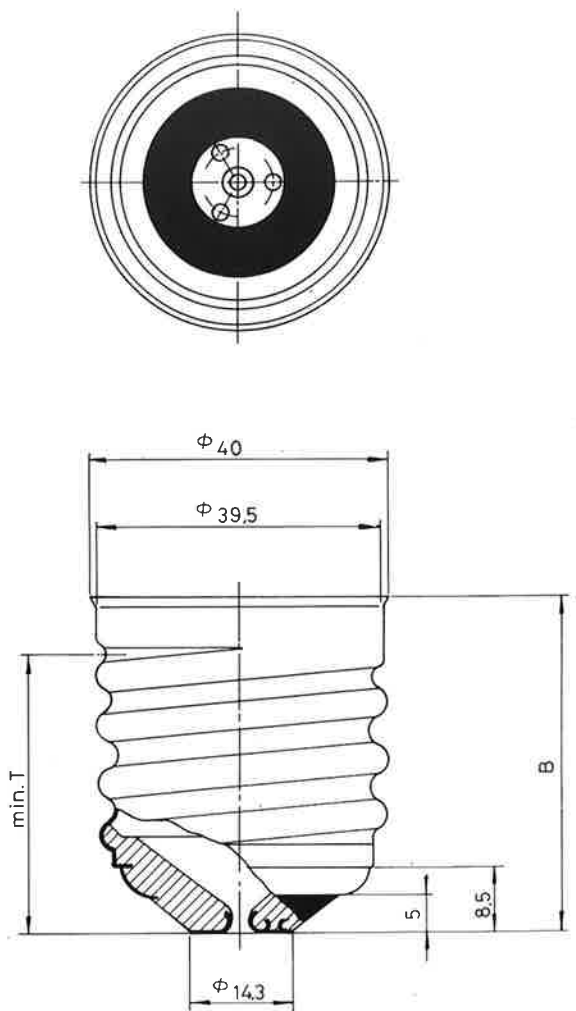

Desig. I.E.C.	Código	B	T		Mat.
E 40/41	E 40.1.239.7	41	34		CuZn
E 40/45	E 40.1.239.10	45	34		CuZn
E 40/45	E 40.1.239.13	45	41		CuZn

E 40

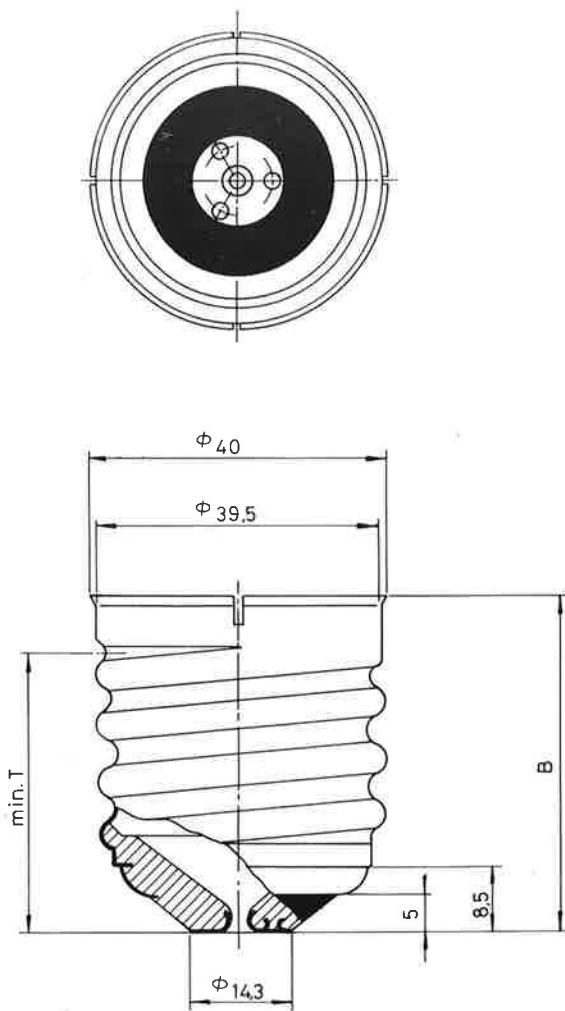

Desig. I.E.C.	Código	B	T	n. ^o entallas	Mat.
E 40/45	E 40.1.239.12	45	34	4	CuZn

E 40

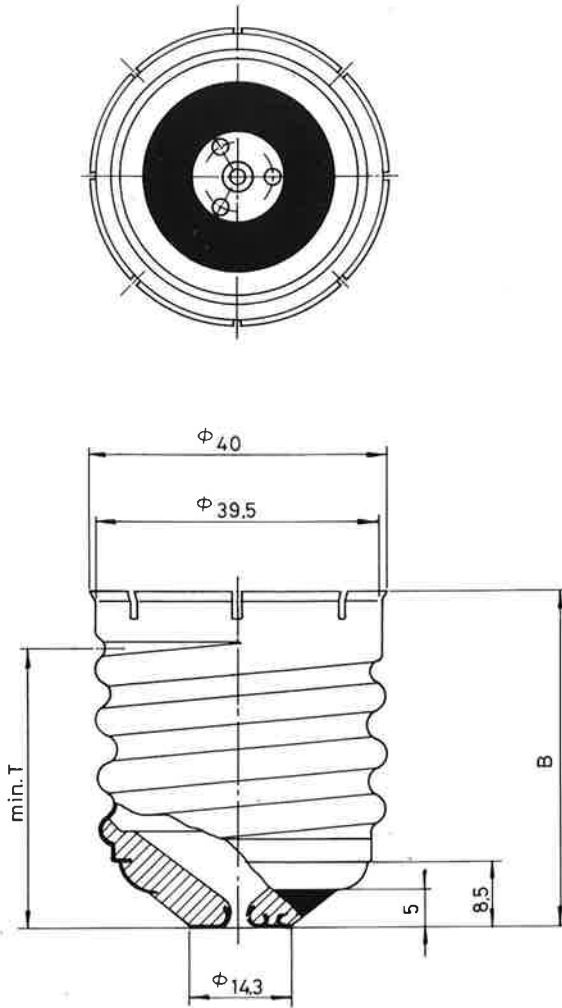

Desig. I.E.C.	Código	B	T	n.º entallas	Mat.
E 40/45	E 40.1.239.9	45	34	8	CuZn

E 40

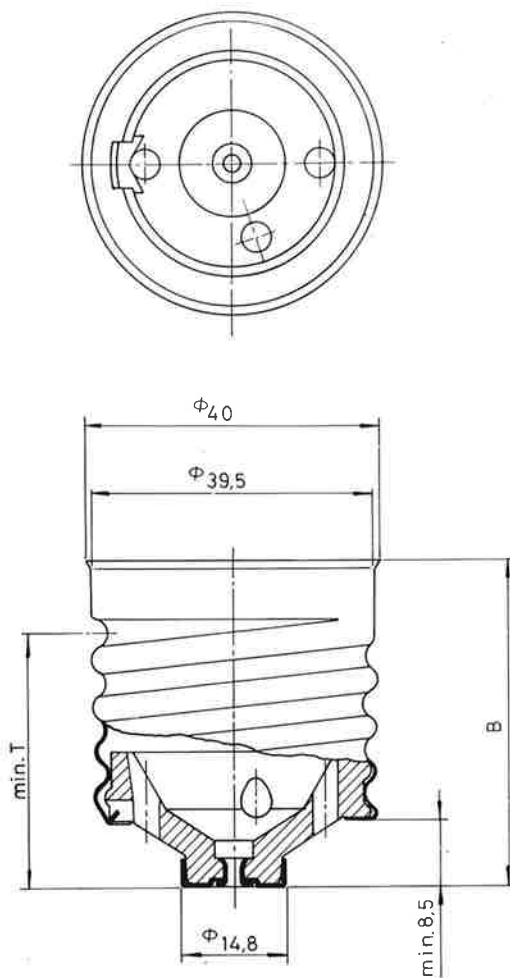

Desig. I.E.C.	Código	B	T		Mat.
E 40/42	E 40.1.239.8	42	34		CuZn
E 40/45	E 40.1.239.6	45	34		CuZn

E 40

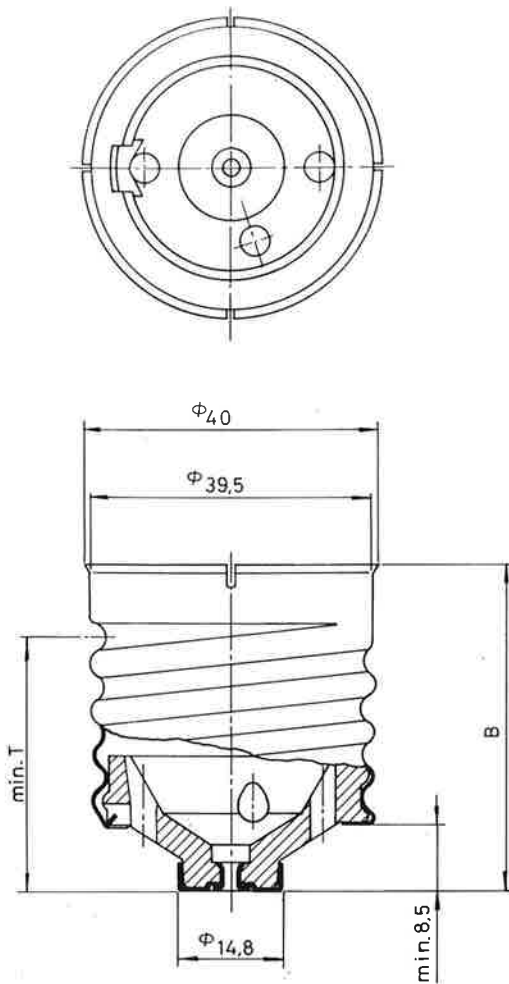

Desig. I.E.C.	Código	B	T	n.º entallas	Mat.
E 40/45	E 40.1.239.5	45	34	4	CuZn

E 40

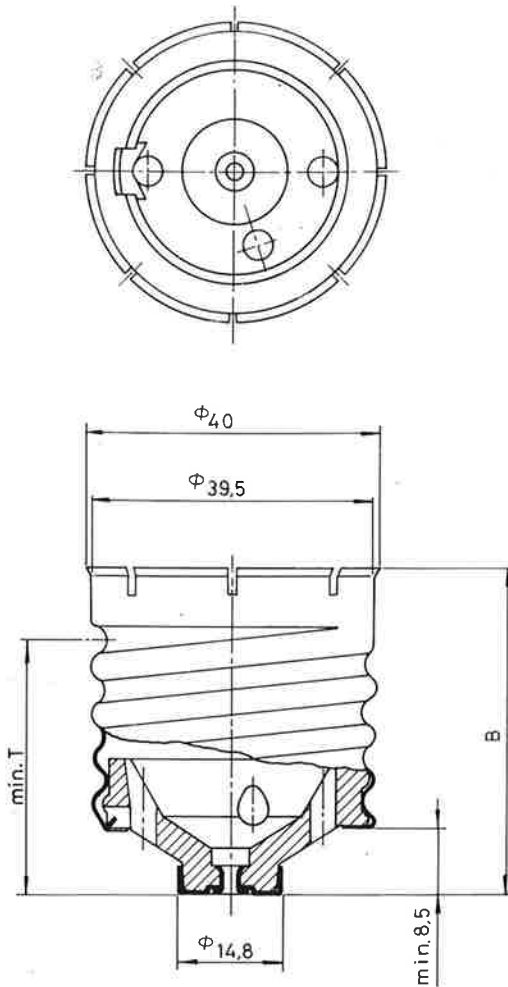

Desig. I.E.C.	Código	B	T	n.º entallas	Mat.
E 40/45	E 40.1.239.1	45	34	8	CuZn

B 15 d

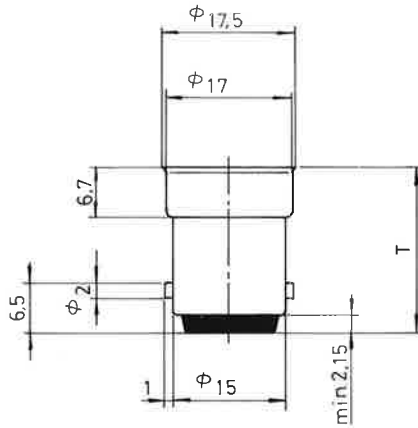
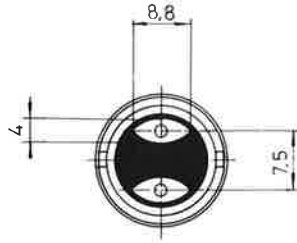

Desig. I.E.C.	Código	T			Mat.
B 15d/22x17	B 00.1.3054.3	22			CuZn
B 15d/24x17	B 00.1.3054.1	24			CuZn

B 22 d

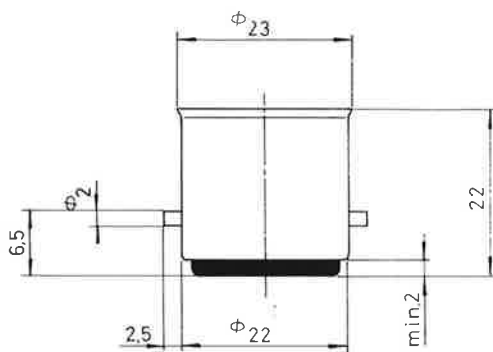
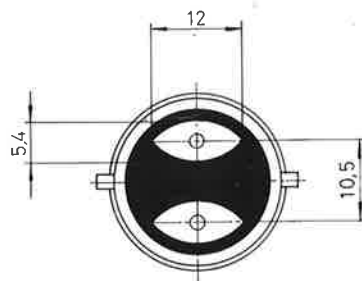

Desig. I.E.C.	Código				Mat.
B 22d/22	B 22.1.603				CuZn

B 22 d

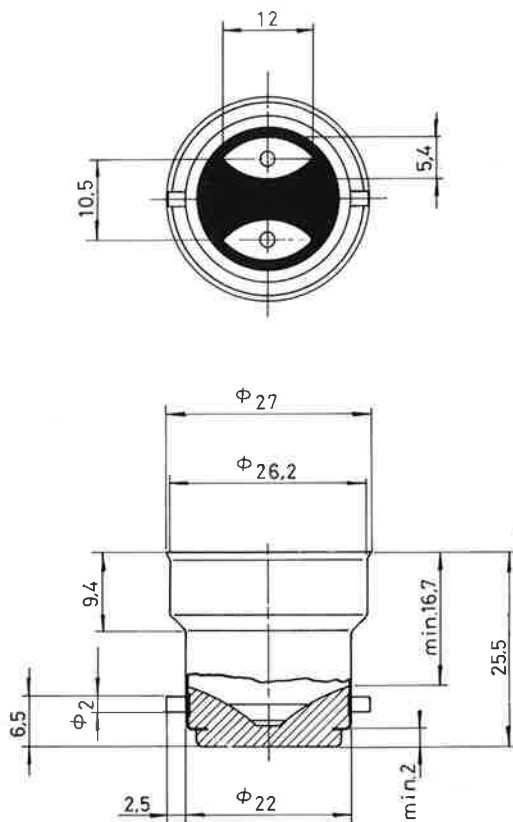

Desig. I.E.C.	Código				Mat.
B 22d/25x26	B 22.1.613				CuZn
B 22d/25x26	B 22.2.613.2				Al.

B 22 d-3

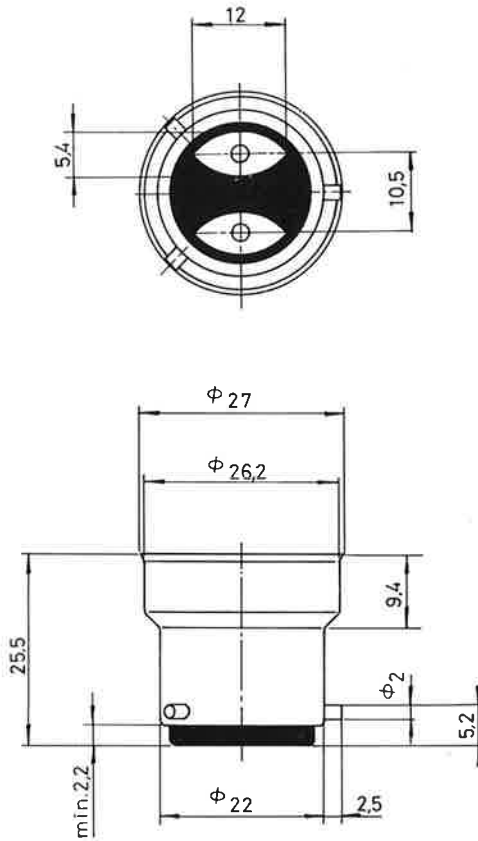

Desig. I.E.C.	Código				Mat.
B 22d-3(90°/135°)/25x26	B 22.1.70				CuZn

BA 9 s

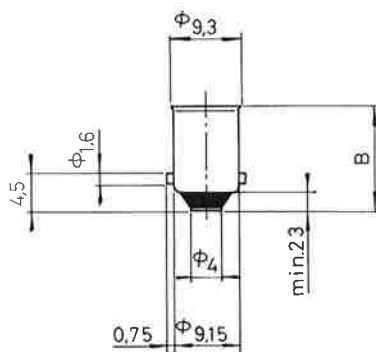

Desig. I.E.C.	Código	B			Mat.
BA 9s/13	BA 9.1.35.2	13			CuZn
BA 9s/14	BA 9.1.35	14			CuZn

BA 9 s

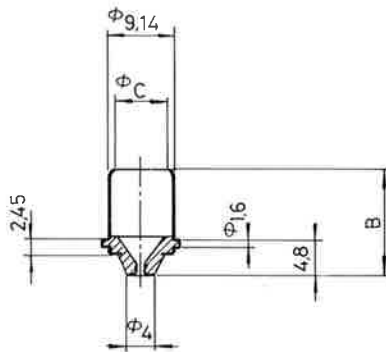
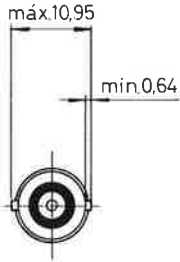

Desig. I.E.C.	Código	B	C		Mat.
BA 9s/14x8	BA 9.1.35.1	14	7,8		CuZn

BA 9 s

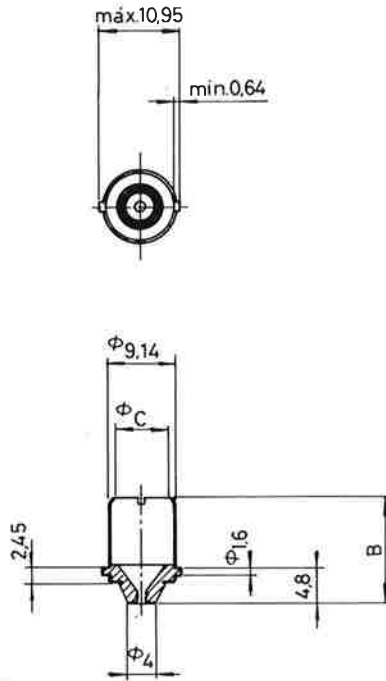

Desig. I.E.C.	Código	B	C	n. ^o entallas	Mat.
BA 9s/13x8,2	BA 9.1.35.4	13	8,2	1	CuZn
BA 9s/14x8	BA 9.1.35.6	14	7,8	1	CuZn

BA 15 s

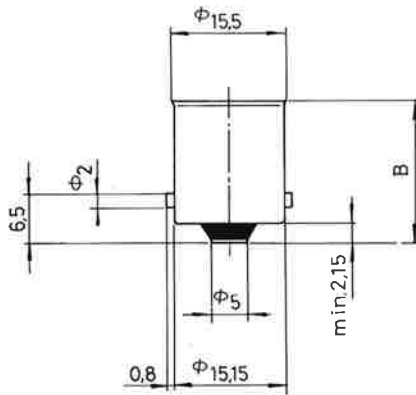

Desig. I.E.C.	Código	B			Mat.
BA 15s/19	B 15.1.536	19			CuZn
BA 15s/20	B 15.1.536.3	20			CuZn

BA 15 s

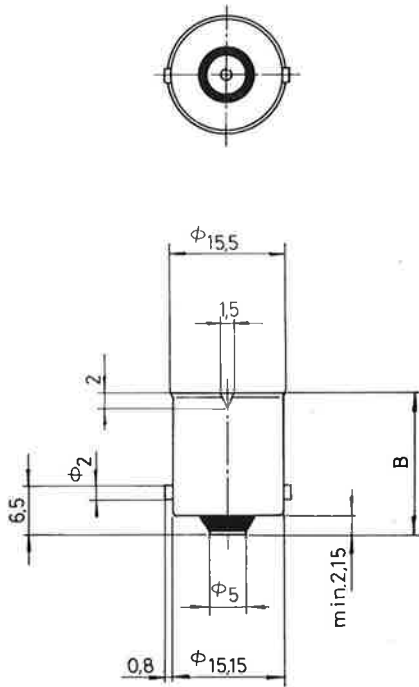

Desig. I.E.C.	Código	B	n. ^o entallas		Mat.
BA 15s/19	B 15.1.536.2	19	1		CuZn
BA 15s/20	B 15.1.536.7	20	1		CuZn

BA 15 s

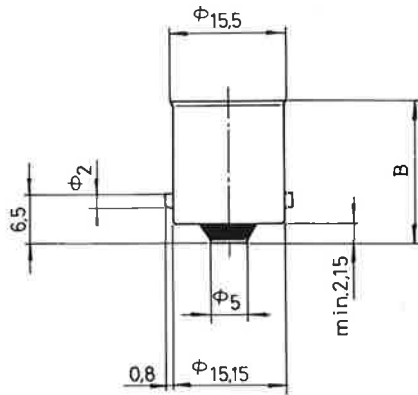
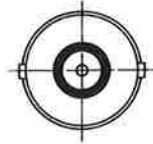

Desig. I.E.C.	Código	B			Mat.
BA 15s/19	B 15.1.536.4	19			CuZn
BA 15s/20	B 15.1.536.6	20			CuZn

BA 15 d

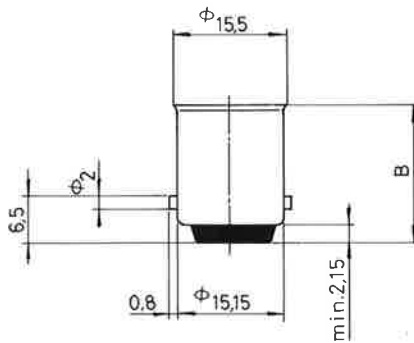
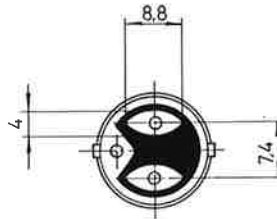

Desig. I.E.C.	Código	B			Mat.
BA 15d/19	B 15.1.574	19			CuZn
BA 15d/20	B 15.1.574.9	20,5			CuZn

BA 15 d

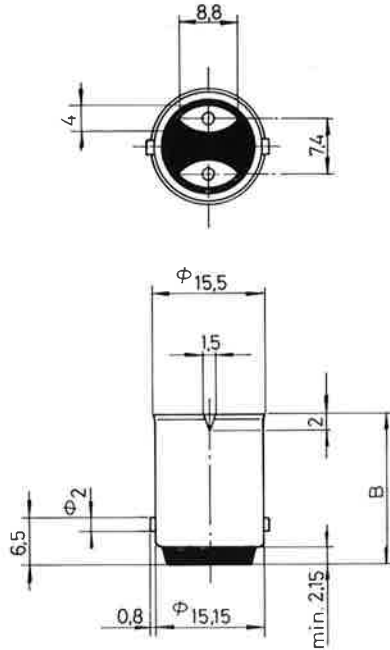

Desig. I.E.C.	Código	B	n. ^o entallas		Mat.
BA 15d/19	B 15.1.574.10	19	1		CuZn
BA 15d/20	B 15.1.574.4	20	1		CuZn

BA 15 d

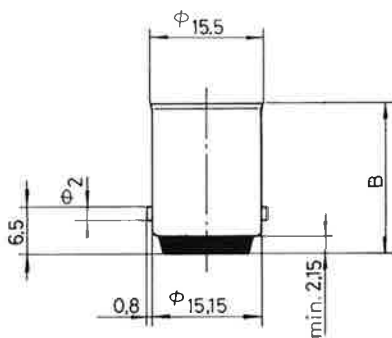
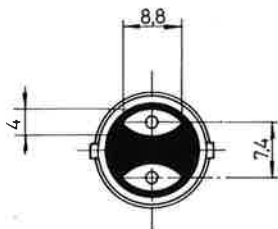

Desig. I.E.C.	Código	B			Mat.
BA 15d/19	B 15.1.574.6	19			CuZn
BA 15d/20	B 15.1.574.2	20			CuZn

BAY 15 d

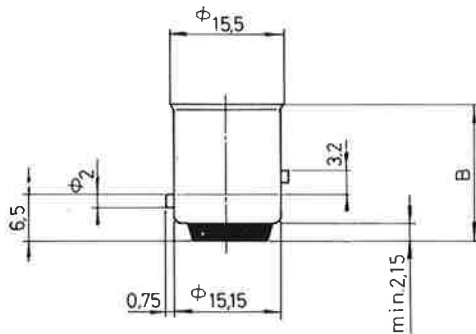
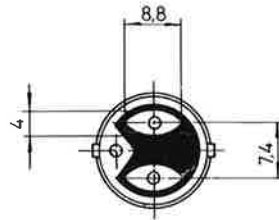

Desig. I.E.C.	Código	B			Mat.
BAY 15d/19	BAY 1.41.1	19			CuZn
BAY 15d/20	BAY 1.41	20			CuZn

BAY 15 d

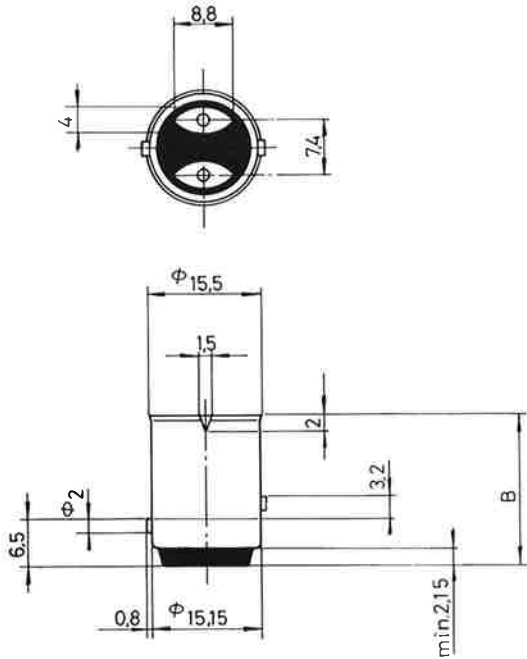

Desig. I.E.C.	Código	B	n. ^o entallas		Mat.
BAY 15d/19	BAY 1.41.3	19	1		CuZn
BAY 15d/20	BAY 1.41.6	20	1		CuZn

BAY 15 d

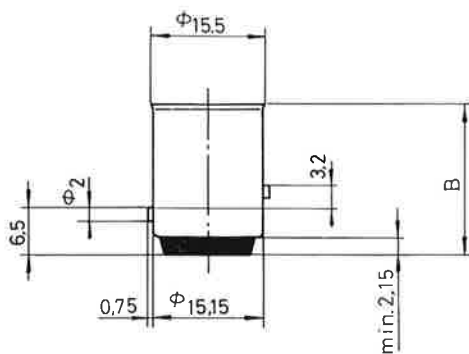
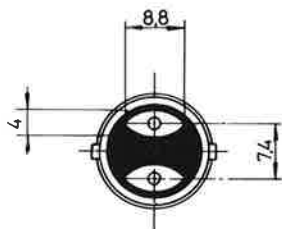

Desig. I.E.C.	Código	B			Mat.
BAY 15d/19	BAY 1.41.4	19			CuZn
BAY 15d/20	BAY 1.41.7	20			CuZn

BA 20 s

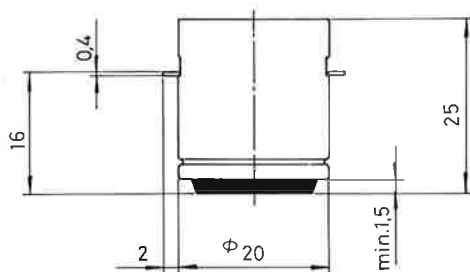
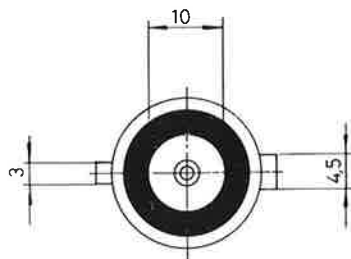

Desig. I.E.C.	Código				Mat.
BA 20s/25	B 20.1.649				CuZn

BA 20 s

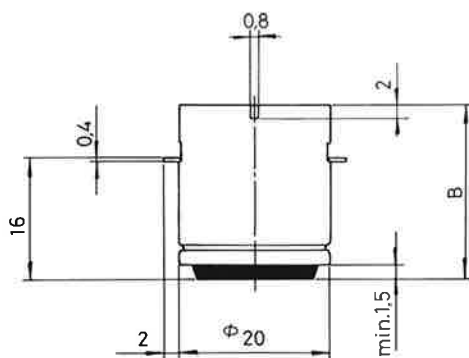
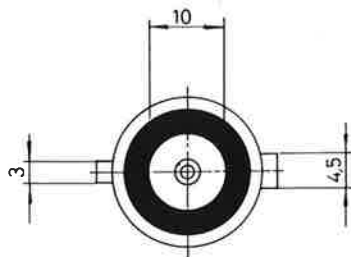

Desig. I.E.C.	Código	B	n.º entallas		Mat.
BA 20s/25	B 20.1.649.1	25	1		CuZn
BA 20s/26	B 20.1.649.2	26	1		CuZn

BA 20 d

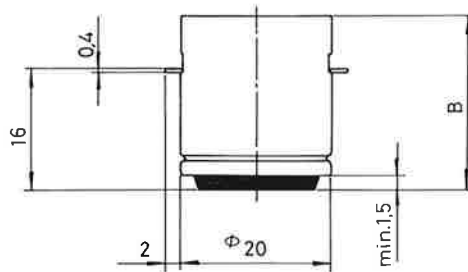
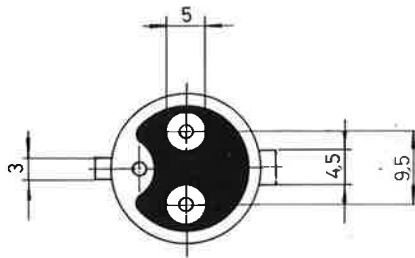

Desig. I.E.C.	Código	B		Mat.
BA 20d/25	B 20.1.650	25		CuZn
BA 20d/26	B 20.1.650.2	26		CuZn

BA 20 caz

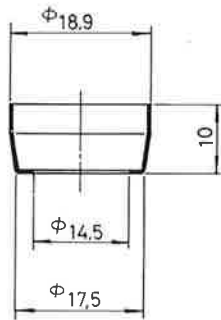

Desig. I.E.C.	Código				Mat.
BA 20 (Cazoleta)	B 20.1.Caz				CuZn

BA 21 s-3

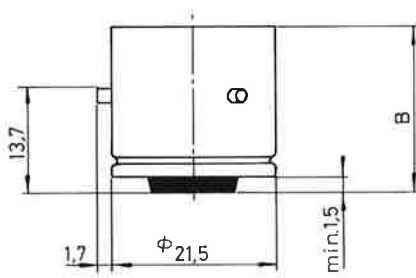
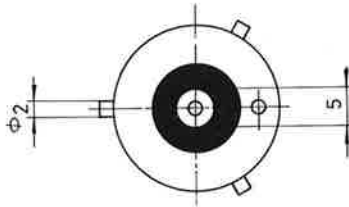

Desig. I.E.C.	Código	B			Mat.
BA 21s-3 (120°)/20	B 21.1.5	20			CuZn
BA 21s-3 (120°)/21	B 21.1.5.2	21,7			CuZn

BA 21 s-4

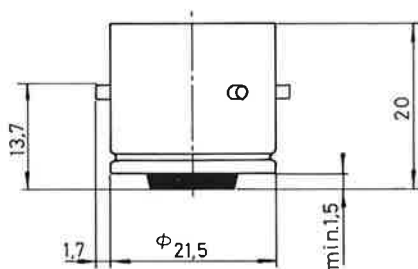
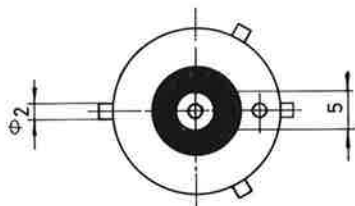

Desig. I.E.C.	Código				Mat.
BA 21s-4 (60°-120°)/20	B 21.1.5.3				CuZn

BA 21 d-3

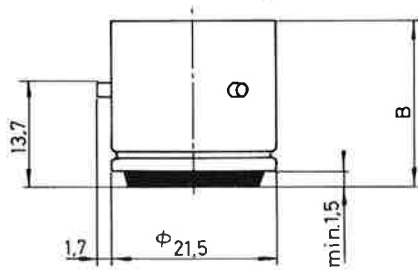
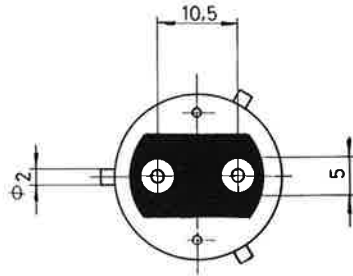

Desig. I.E.C.	Código	B			Mat.
BA 21d-3 (120°)/20	B 21.1.5 Bis	20			CuZn
BA 21d-3 (120°)/21	B 21.1.5 Bis.7	21,7			CuZn

BA 21 d-4

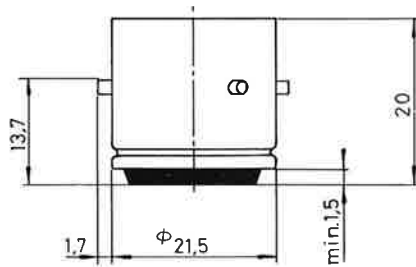
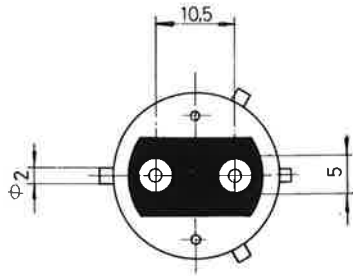

Desig. I.E.C.	Código				Mat.
BA 21d-4 (60°-120°)/20	B 21.1.5 Bis.8				CuZn

BA 21 caz

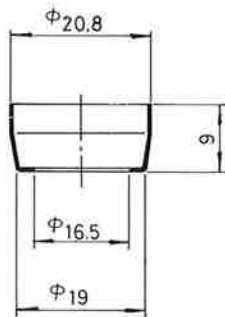

Desig. I.E.C.	Código				Mat.
BA 21 (Cazoleta)	B 21.1.Caz				CuZn

SV 6

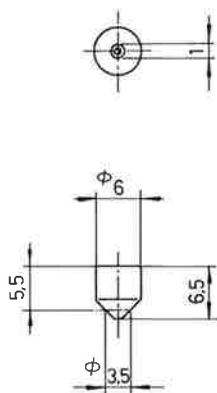

Desig. I.E.C.	Código				Mat.
SV 6-5,5/6,5	SVO. 1.42				CuZn

SV 6

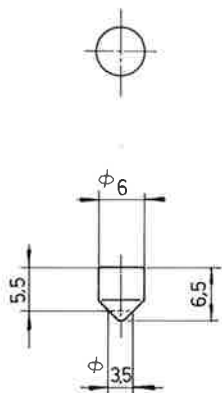

Desig. I.E.C.	Código				Mat.
SV 6-5,5/6,5	SVO. 1.42.2				CuZn

SV 7

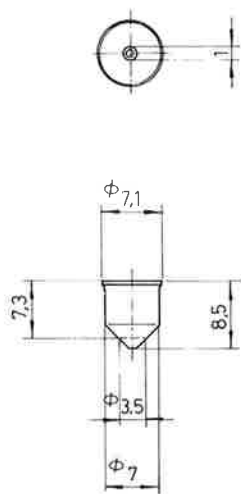

Desig. I.E.C.	Código				Mat.
SV 7-7,3/8,5	SVO. 1.40.Bis				CuZn

SV 8'5

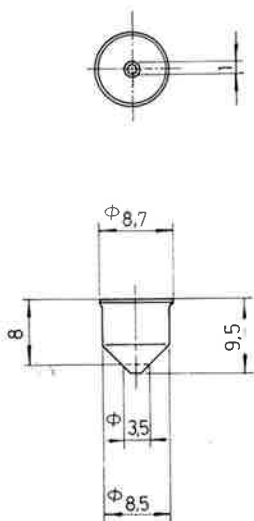

Desig. I.E.C.	Código				Mat.
SV 8,5-8/9,5	SVO. 1.44				CuZn

SV 8'5

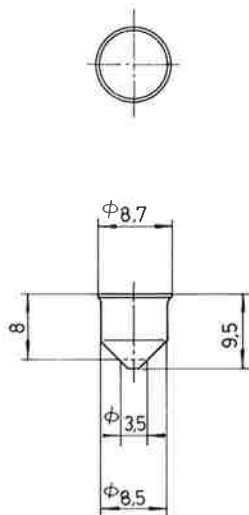

Desig. I.E.C.	Código				Mat.
SV 8,5-8/9,5	SVO. 1.44.1				CuZn

SV 9'5

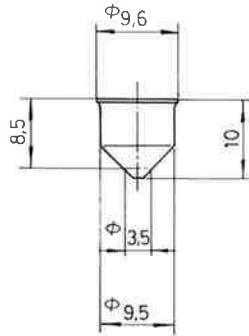
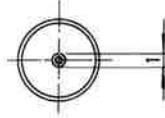

Desig. I.E.C.	Código				Mat.
SV 9,5-8,5/10	SVO. 1.43				CuZn

S 14 s

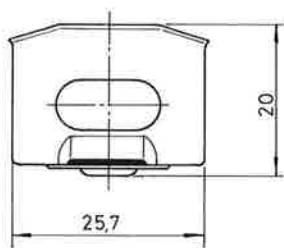
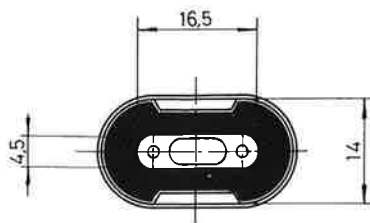

Desig. I.E.C.	Código				Mat.
S 14s	S 14.1.S14s				CuZn

S 15

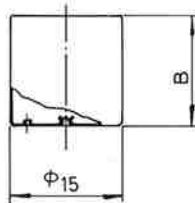
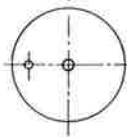

Desig. I.E.C.	Código	B			Mat.
S 15/15	S 15.1.48.1	15			CuZn
S 15/20	S 15.1.48	20			CuZn
S 15/20	S 15.2.48.6	20			Al.

S 15 s

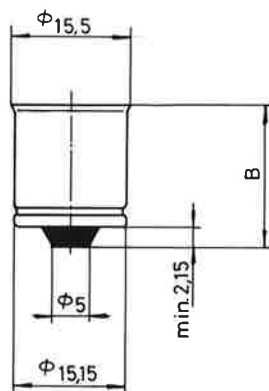

Desig. I.E.C.	Código	B			Mat.
S 15s/17	S 15.1.48.10	17			CuZn
S 15s/18	S 15.1.48.11	18			CuZn
S 15s/19	S 15.1.48.9	19			CuZn

S 19

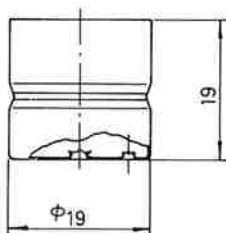
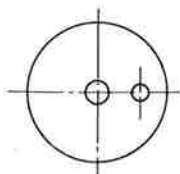

Desig. I.E.C.	Código				Mat.
S 19/19	S 19.1.50				CuZn

S 19

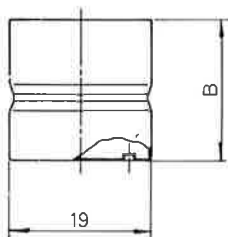
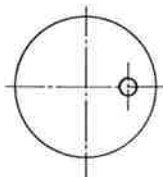

Desig. I.E.C.	Código	B			Mat.
S 19/19	S 19.2.50.1	19			Al.
S 19/20	S 19.2.50.4	20			Al.
S 19/21	S 19.2.50.5	21			Al.

S 19

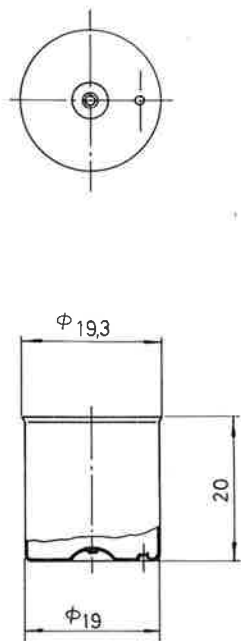

Desig. I.E.C.	Código				Mat.
S 19/20	S 19.1.50.6				CuZn
S 19/20	S 19.2.50.2				Al.

S 22 s

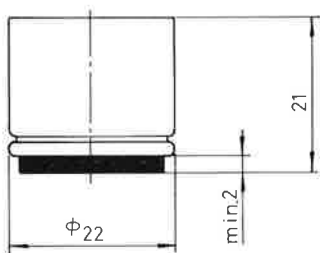

Desig. I.E.C.	Código				Mat.
S 22s/21	S 22.1.45.1				CuZn

S 22 d

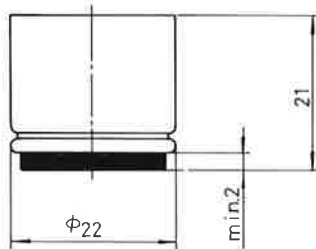
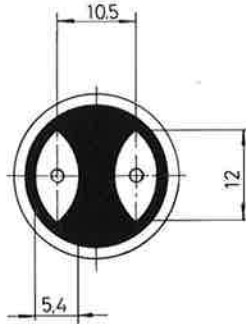

Desig. I.E.C.	Código				Mat.
S 22d/21	S 22.1.45				CuZn

P 36

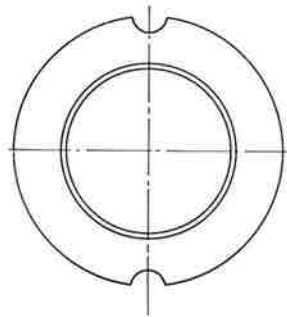
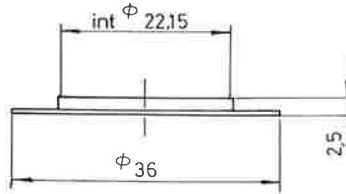

Desig. I.E.C.	Código				Mat.
P 36	P 36.1.46				CuZn

P 28 s

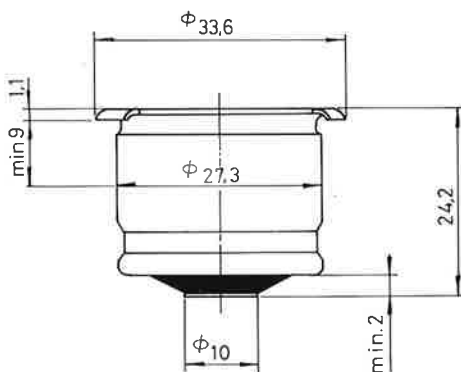
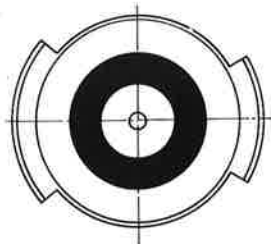

Desig. I.E.C.	Código				Mat.
P 28s/24	P 28.1.62				CuZn

P 28 caz

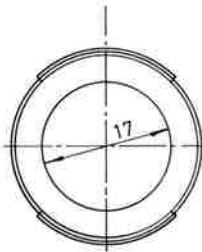
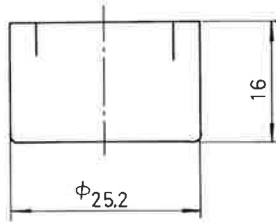

Desig. I.E.C.	Código				Mat.
P 28 (Cazoleta)	P 28.1.Caz				CuZn

P 45 t-41

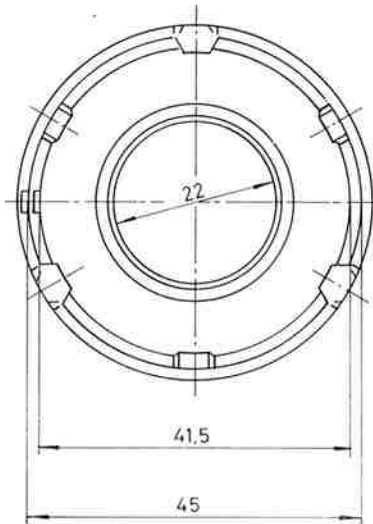
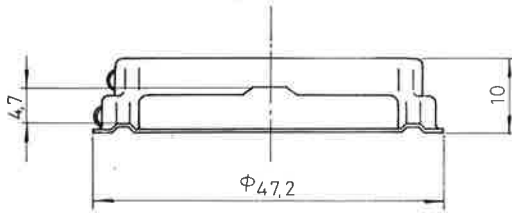

Desig. I.E.C.	Código				Mat.
P 45t-41	P 46.5.78.1				CuZn

G 16 t

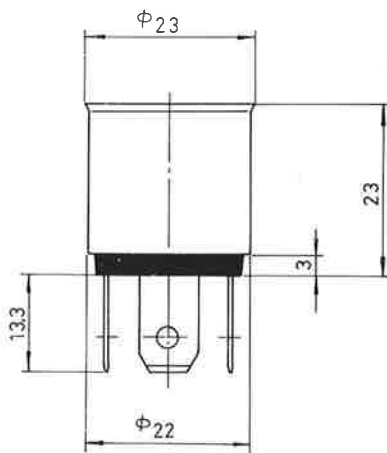

Desig. I.E.C.	Código				Mat.
G 16t/23x22	G 16.5.9N				CuZn

G 5

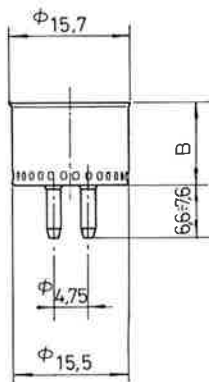
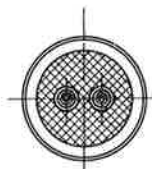

Desig. I.E.C.	Código	B			Mat.
G 5/11x15	G 12.2.Z1511	11			Al.

G 13

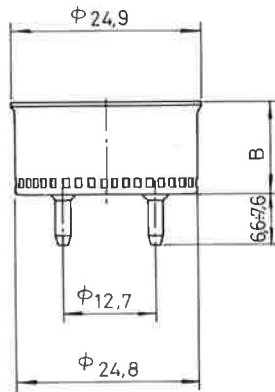
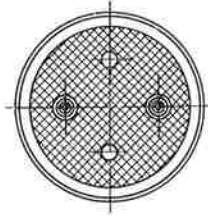

Desig. I.E.C.	Código	B			Mat.
G 13/9,5x24	G 22.2.Z249,5	9,5			Al.
G 13/10x24	G 22.2.Z2410	10			Al.
G 13/11x24	G 22.2.Z2411	11			Al.
G 13/12x24	G 22.2.Z2412	12			Al.

G 13

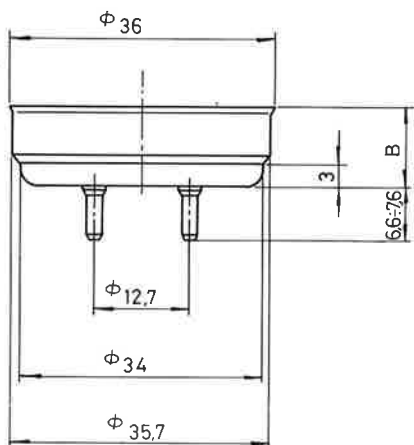
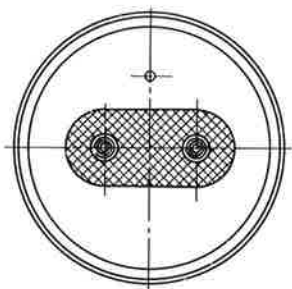

Desig. I.E.C.	Código	B			Mat.
G 13/10x35	G 30.2.03510	10			Al.
G 13/10,5x35	G 30.2.03510,5	10,5			Al.
G 13/11x35	G 30.2.03511	11			Al.

G 13

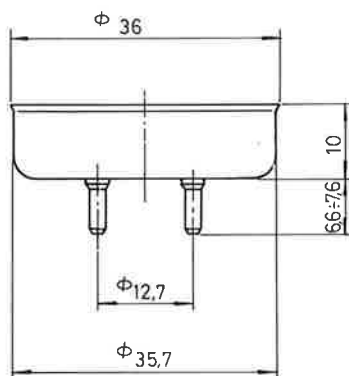
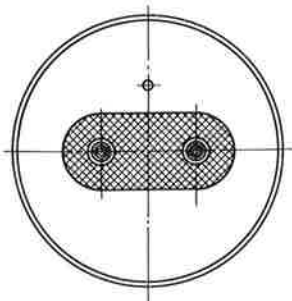

Desig. I.E.C.	Código				Mat.
G 13/10x36	G 3T.2.T3510				Al.

G 13

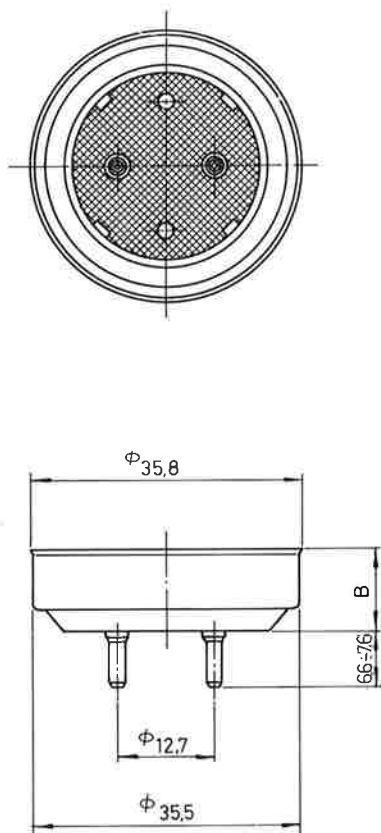

Desig. I.E.C.	Código	B			Mat.
G 13/9,5x35	G 3Z.2.Z359,5	9,5			Al.
G 13/10x35	G 3Z.2.Z3510	10			Al.
G 13/11x35	G 3Z.2.Z3511	11			Al.
G 13/12x35	G 3Z.2.Z3512	12			Al.

ROSCA EDISON

Notaciones y medidas

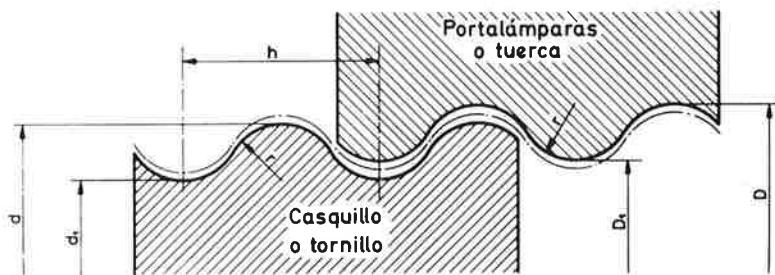

NOTACION	TORNILLO				TUERCA			
	\varnothing exterior d		\varnothing del núcleo d'		\varnothing int. del núcleo D		\varnothing externo D'	
	máximo	mínimo	máximo	mínimo	mínimo	máximo	mínimo	máximo
E 10	9,53	9,36	8,51	8,34	9,61	9,78	8,59	8,76
E 14	13,89	13,70	12,29	12,10	13,97	14,16	12,37	12,56
E 27	26,38	26,05	24,19	—	26,55	—	24,36	24,66
E 40	39,50	39,05	35,90	35,45	39,60	40,05	36,00	36,45

NOTACION	N.º DE FILETES POR 1"	PASO DE ROSCA	RADIO DEL FILETE
—	—	h	r
E 10	14	1,814	0,531
E 14	9	2,822	0,822
E 27	7	3,629	1,025
E 40	4	6,350	1,850

Cotas estándar de los casquillos de bayoneta más corrientes

BAYONETA AUTOMOVIL

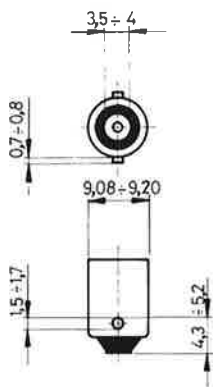

BA 9

BAYONETA AUTOMOVIL

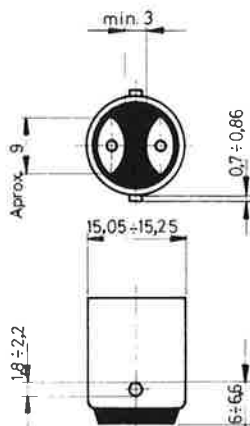

BA 15

BAYONETA NORMAL

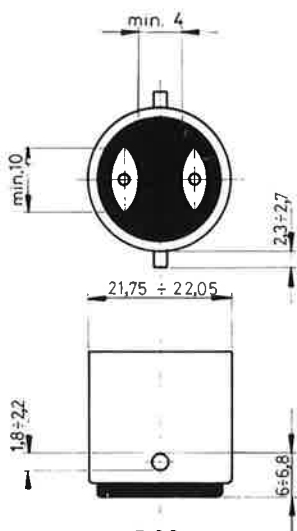

B 22

